

Wildwood is the creation of plant and garden enthusiasts Wayne and Sue Tapping. They began this garden more than 30 years ago and also opened a retail nursery at near by North Richmond. The nursery closed in 2010, allowing the couple to pursue their dream of an open garden with gift shop, nursery and tearoom.

This two hectare garden nestles among 10ha of towering native trees. It is set on a gentle slope with broad, crushed granite paths that meander beside a waterfall and ponds, then wind beneath the trees and across sweeping lawns to a tranquil lake. Seats are scattered throughout to encourage visitors to relax and enjoy the atmosphere.

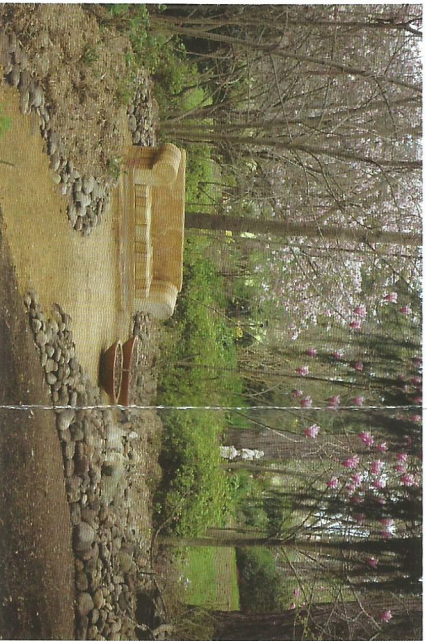
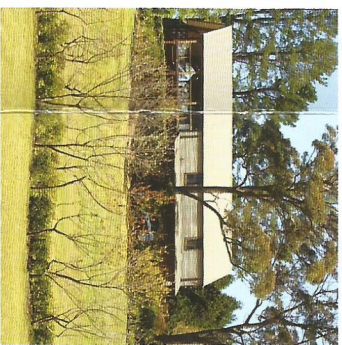

## TEAROOM

Wildwood's tearoom serves morning and afternoon teas, snacks and light lunches with delicious sandwiches, salads, cakes, pastries and seasonal specials. Enjoy a panoramic view over the garden from the tearoom's verandah. Visitors are also welcome to picnic by the lake.

## GIFT SHOP & NURSERY

The shop is well stocked with appealing giftware and local products. The nursery has a range of plants, many of which are propagated from those growing in the garden. You are sure to find something special here.

*Discover the beauty of Wildwood garden in the heart of the Blue Mountains. It's just 90 minutes from Sydney.*

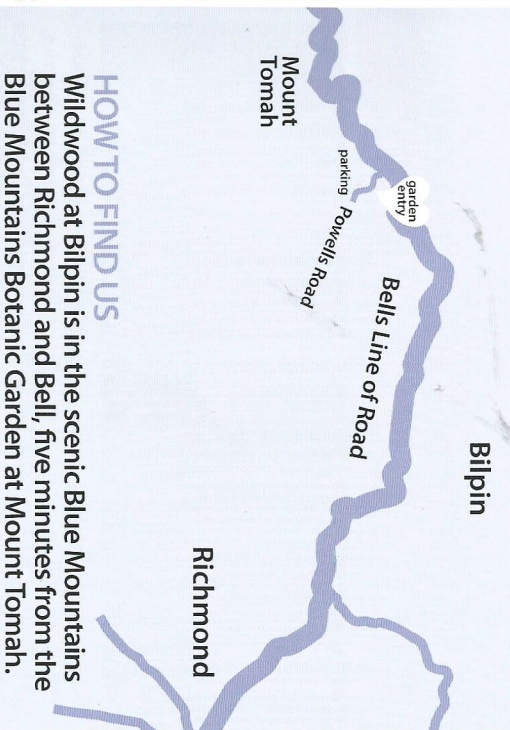

## HOW TO FIND US

Wildwood at Bilpin is in the scenic Blue Mountains between Richmond and Bell, five minutes from the Blue Mountains Botanic Garden at Mount Tomah.

## OPENING TIMES

The garden is open Friday to Monday for Autumn and Spring and at other times by appointment.

Autumn Opening: 20 March to 8 June, 2015

Spring Opening: 7 August to 2 November, 2015

Opening Hours: Friday to Monday, 10am to 4pm

## GARDEN ADMISSION

Adults: \$8.00

Concession: (seniors, students, disabled) \$6.00

Children: under 16 FREE

Garden Entry Prices: to rise for Spring season 2015

Groups welcome by appointment • Parking available

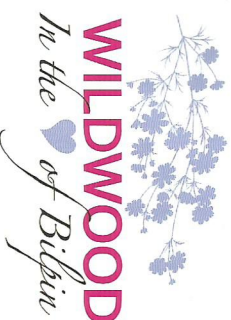

Wildwood, 29 Powells Road, Bilpin, NSW 2758

Website [www.wildwoodgarden.com.au](http://www.wildwoodgarden.com.au)

Phone 0417 042 460 or AH (02) 4567 2194

Email [wtapping@bigpond.net.au](mailto:wtapping@bigpond.net.au)



## A GARDEN FOR EVERY SEASON



In late winter the magnolias, hellebores, daphnes and bulbs bloom. With more than 600 camellia varieties there's always a show to enjoy from these evergreen shrubs.

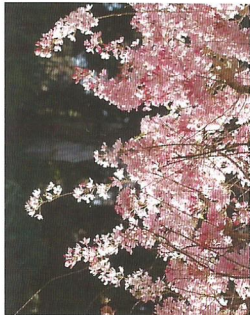

Spring arrives with a parade of blooms as azaleas, cherries, dogwoods and wisterias burst into flower. Japanese maples are delightful in their fresh green and red new growth.



By summer the garden is a retreat with shady walks amid banks of blue hydrangeas and green leaves. The waterfall adds a cool note. In sunny spots colourful roses thrive.



As the days shorten, the many deciduous trees turn red, gold, orange and yellow, reaching full colour in May. Roses continue to wow as camellias begin their show.

Wildwood celebrates the seasons with a collection of cool climate plants that thrive in the mild climate and deep volcanic soils of this cool mountain region.

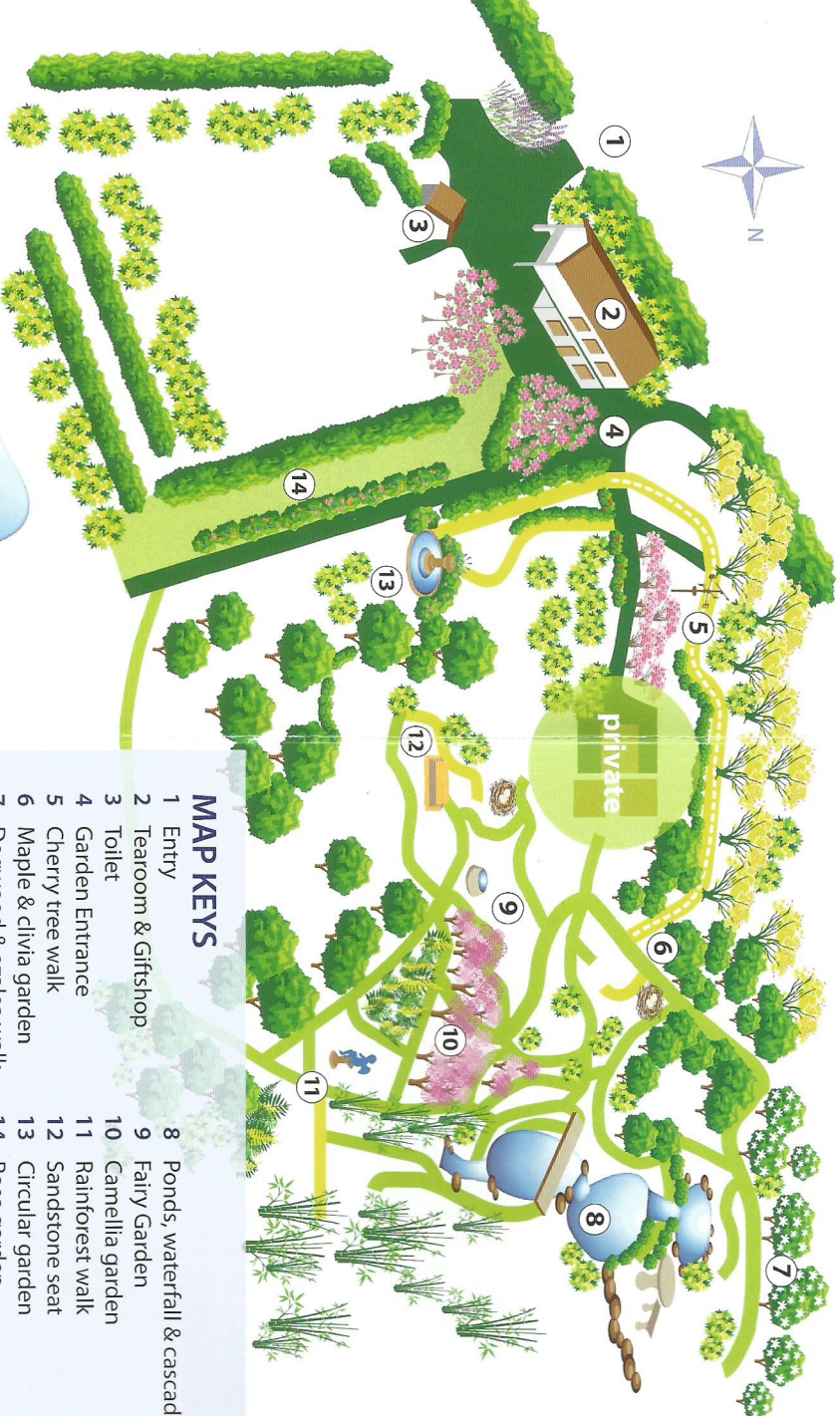

### MAP KEYS

- |                         |                               |
|-------------------------|-------------------------------|
| 1 Entry                 | 8 Ponds, waterfall & cascades |
| 2 Tearroom & Giftshop   | 9 Fairy Garden                |
| 3 Toilet                | 10 Camellia garden            |
| 4 Garden Entrance       | 11 Rainforest walk            |
| 5 Cherry tree walk      | 12 Sandstone seat             |
| 6 Maple & clivia garden | 13 Circular garden            |
| 7 Dogwood & azalea walk | 14 Rose garden                |

GARDENS | TEAROOM | GIFTS | PLANTS

  
**WILDWOOD**  
*In the heart of Bilpin*

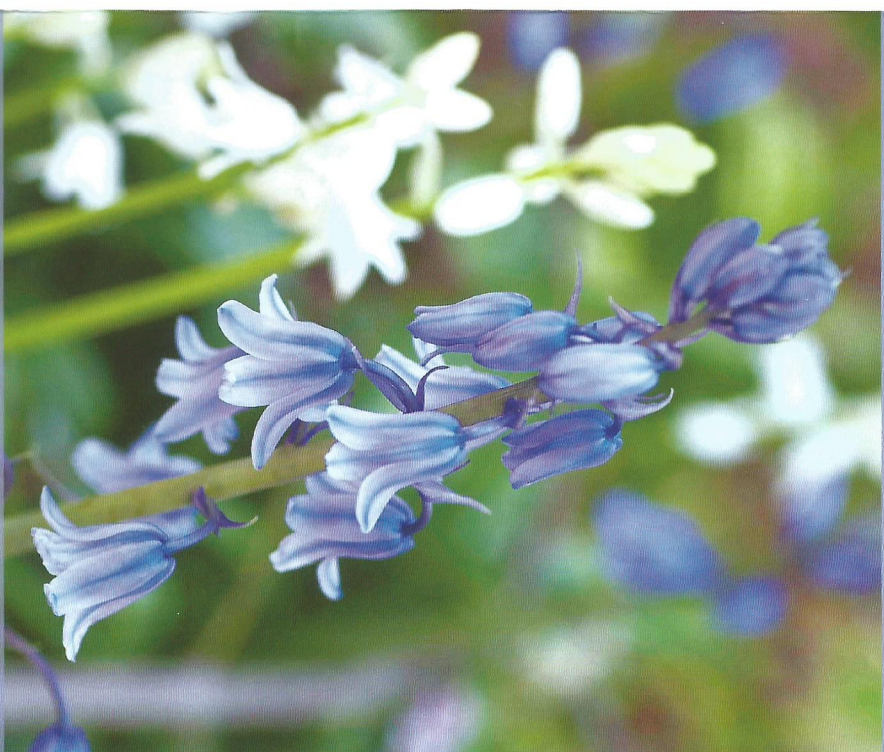

*Bilpin NSW*

- ♥ Magnificent cool climate garden
- ♥ Relax in the mountain air
- ♥ Refreshments, gift shop & nursery